

TWR



- Our Patented AquaRecycle® System is designed to maximize water and energy savings in Tunnel Washer operations while providing the finest recycled laundry wash water
- TWR stands for Tunnel Washer Recycler and the recycle system is compact and easy to install and operate
- Documented and Guaranteed Water and Energy savings at 70% reduction in water costs and 50% of energy costs
- Available in 6 convenient sizes - XSMALL, SMALL, MEDIUM, LARGE, XLARGE and MAXIMUM
- Includes AquaSmart™ 6.0, a high speed Secure Private Network providing 24/7 data and error detecting software to maximize performance



Aquarecycle®
TWR System
with
AQUASMART™

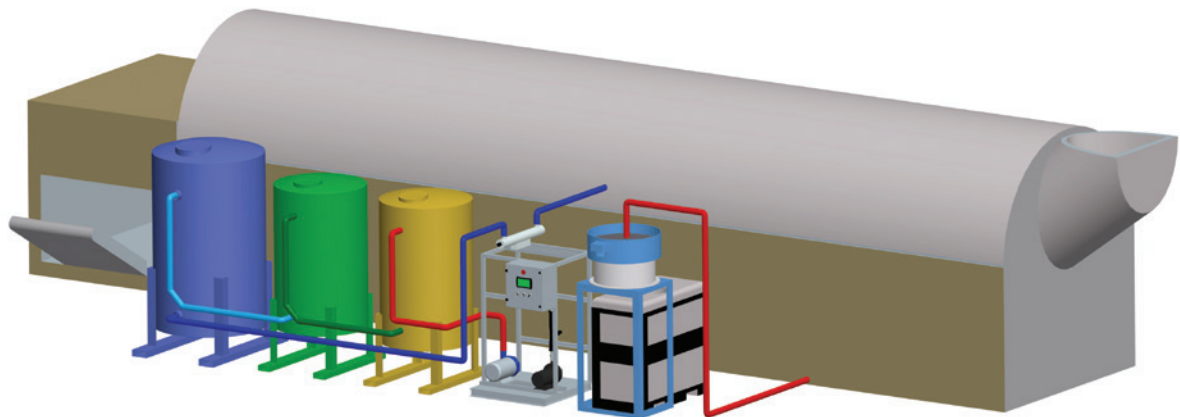

Call today for a FREE savings analysis!

1.866.272.9253

www.aquarecycle.com

TWR

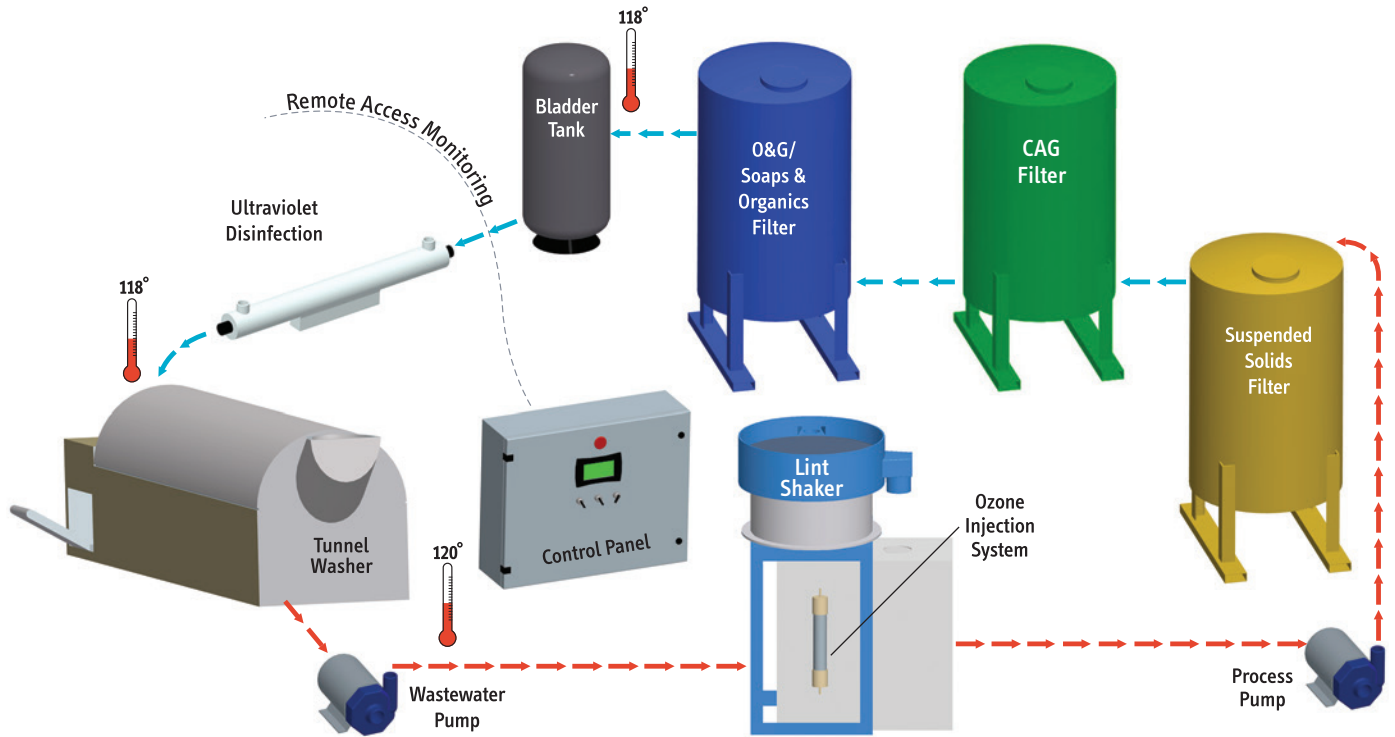

SIMPLE OPERATION

- Laundry Wash Water from the washers is pumped to our Lint Vibration and Removal System for large solids removal
- Our process pump sends the filtered water through our Specially Formulated Media Tanks which removes remaining Suspended Solids, Oil and Grease, Chemical Soaps and Detergents, Dissolved Organics and other contaminants
- CAG Filter, UV and Ozone Disinfection System provides a Triple Assault on bacteria and virus before the recycled water is sent back to the hot and cold-water lines using a high speed Supply pump
- Recycled Water maintains 100% return of heat in the water back to washers to maximize energy savings

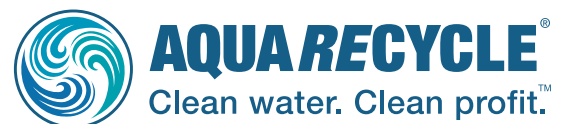

Call today for a FREE savings analysis!

1.866.272.9253

www.aquarecycle.com